

Safety Precautions

- Please read these "Safety Precautions" carefully before use, then use the product correctly.
- These cautions are provided to ensure safe and proper use of the product, and to keep the user and others free from harm or damage.

- WARNING** This symbol indicates that handling the product incorrectly could cause an accident.
- Handling the product contrary to these warnings could result in death or serious injury.
- CAUTION** This symbol indicates that handling the product incorrectly could result in serious injury or property damage.

- This symbol indicates matters that are prohibited or require confirmation. Handling the product incorrectly could cause an accident.
- This symbol indicates prohibited actions. Illustrations next to this symbol provide clarification.
- This symbol indicates content that must be checked by adults.

Be sure to follow these instructions

WARNING

- Do not set in an area accessible by toddlers or infants. Also be sure that it is not used for playing or pranks. (This could lead to a serious accident, causing injury, etc.)
- Keep away from fire, such as a heater or stove. (Failure to do so may cause a fire to occur, and/or deform/discolor the product.)
- Do not exercise while using the shoulder strap. Also, refrain from use while playing on playground equipment. (Doing so is very dangerous, as it could become entangled or tightened around the body, causing serious injury.)
- Do not wear the shoulder strap around the neck. Instead, put it across one shoulder to hang diagonally.
- Do not handle the product recklessly by swinging it around, etc. (Doing so is very dangerous, as it may cause the product to unintentionally hit you or others, leading to an accident.)
- Before operating the open/close lever, be sure to position the product upright. (When the product is filled with a hot drink, be careful not to burn yourself, since pressure will rise causing steam to blow out.)
- Fill up to the limit shown in the figure on the right. (Filling it too high may cause leakage or overflow, leading to burns or soiling of property.)

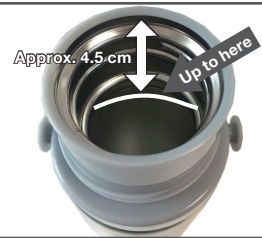

Be sure to attach parts made exclusively for this product.

CAUTION

Be sure to follow these instructions

CAUTION

WARNING Please note that, if these precautions are not followed correctly, our company will not be held responsible.

- Only use this product to keep beverages warm or cool.
- Do not subject the product to significant shock by dropping it or hitting it against something. (If the surface is dented, it may reduce the product's heat-retaining/cooling capabilities.)
- Do not use chlorine bleach.
- Do not use paint thinner, benzene, metal scrubbers, polishing powder, cleansers, etc. (Doing so could scratch the product or lead to rust, causing it to malfunction.)
- Do not allow a hot tea kettle to touch the metal parts of this product. (Doing so may scratch or deform the product.)
- Do not use a dishwasher or dryer to clean this product. (Doing so may scratch or deform the product.)
- Loosen the inner stopper when storing the product to protect the gasket during long periods of non-use.
- Do not put cans of juice etc. in the container. (Doing so may deform the product, causing malfunction.)
- Be sure to break pieces of ice into smaller pieces before putting them in the product.
- Do not wash the main unit while fully assembled. (Water may seep in, causing rust to form, or soil other property.)
- When storing the product in a bag, be sure the main unit is upright to prevent leakage. Also, be sure not to carry it in a bag with valuables inside (such as a mobile phone or camera).
- When keeping hot tea in the product for a long period of time, the tea may change color. Tea bags etc. are recommended for going out.
- After use, wash the main unit (inner container) with a long-handled sponge or similar. (This will prevent odors.)
- Always attach the cup when carrying the product. (This prevents the inner stopper from getting dirty.)
- The inner stopper and cup are made of plastic, and may be damaged when used improperly. Do not subject the product to significant shock by dropping it or hitting it against something.

Never fill the product with the following:

CAUTION

- Dry ice or carbonated drinks (Doing so will cause a rise in pressure, preventing the inner stopper from opening, or content to blow out dangerously.)
- Miso or other salty soups (Although the inner bottle is made of stainless steel, these may cause the product to rust.)
- Milk, milk-based beverages, fruit juice, etc. (The ingredients could spoil.)
- Pulp or tea leaves (These may get stuck, causing the product to leak or malfunction.)

How to Use

Always pour hot drinks into the cup. (Drinking directly from the product could cause burns.)

WARNING

- Pre-cooling/pre-heating the main unit (inner container) in advance will allow you to maintain the desired temperature more effectively.

Inner stopper precautions

CAUTION

- Do not place the cup, inner stopper, or main unit in boiling water. (Doing so may deform or discolor the product, leading to malfunction.)
- Use this product in the upright position. (Turning it upside down may cause leakage.)
- Before using this product, securely attach the inner stopper to the main unit. (Failure to do so may result in leakage.)
- Before operating the open/close lever, be sure to place the product on a level surface and hold the main unit firmly.
- Do not use a dishwasher, dryer, or boiling water to wash this product. (Doing so may deform the product, causing the stopper to loosen.)
- After storing a hot beverage in the product, be sure the main unit and inner stopper have completely cooled before washing.

When pouring hot or cold drinks into the cup

CAUTION

- When using ice in this product, liquid may not flow out as quickly when pouring or drinking.
- When pouring a drink, place the cup on a level surface, hold the main unit firmly, and pour slowly.
- After pouring in a hot drink, the open/close lever may be difficult to operate due to an increase in pressure.
- Be especially careful when pouring hot drinks.
- After pouring liquid into the cup, place the main unit on a level surface, and firmly press the open/close lever to close the stopper.
- Grasp the cup firmly when drinking. (Be careful not to burn yourself when drinking hot beverages.)
- After using the cup, wipe out any remaining liquid and reattach it to the main unit.
- Always pour hot drinks into the cup to drink. Do not drink from the product directly, since you could suffer burns.

How to use the inner stopper

Before operating the open/close lever, be sure to position the product upright. (When the product is filled with a hot drink, be careful not to burn yourself, since pressure will rise causing steam to blow out.)

WARNING

- Place the product on a level surface and remove the cup. (It can be removed by turning counterclockwise when viewed from the top of the product.)
- Pull the inner stopper's open/close lever upward towards the arrow until it clicks. (It may be difficult to operate due to increased pressure.)
- When you hear a click, it is ready to be poured (or drunk). Refer to the explanation on page 4 to use the product. (The liquid content may come out quickly, so be especially careful with hot drinks.)



- When finished pouring or drinking liquid, lightly push down on the open/close lever from the top to close the stopper.
- After closing the stopper, lightly tighten the cup.

How to attach and remove the gasket

The gasket can be washed.

- Pull up the open/close lever. Attach the gasket in the direction shown in the photo below.
 - Do not intentionally pull or push under the valve. (Otherwise, failure or water leakage could occur.)
 - Be sure the gasket is inserted properly. (Otherwise, water leakage could occur.)
- Remove the gasket.
 - This may be difficult. Perform this step carefully.
- Pay attention to the top and bottom of the gasket when attaching it. Also, make sure to mount it uniformly. Attach the gasket in the direction shown in the photo below.
 - After assembly, operate the open/close lever to make sure it works properly. Also confirm there is no space between the inner stopper and its gasket.

Product Care

To prevent odors, soiling, and mold so that this product can remain clean for long-term usage, be sure to perform the following care steps after use.

Always perform product care after use.

CAUTION

- Do not leave the main unit soaked when washing. Doing so may cause water to seep between plastic and metal parts, causing rust to form or soiling other property.
- Do not use a dishwasher or dryer to clean this product. (Doing so may scratch or deform the product.)
- The inner stopper can be washed by first removing its gasket.
- Use a mild dish detergent for regular product care. If the product is dirty, wash with running water, then wipe it down with a dry cloth.
- Do not use a dishwasher or dryer to clean this product. (Doing so may scratch or deform the product.)
- Do not use chlorine bleach. (Doing so may cause internal spring to rust)
- Do not set to soak.
- The inner stopper cannot be disassembled.

The inner stopper is an expendable part. If it becomes damaged, replace with a new one (sold separately).

CAUTION

- This is iron content, etc. contained in water stuck to the product. Dilute about 10% vinegar in warm water, put it in the container for about 30 minutes, then scrub clean with a soft brush.
- This is due to mineral buildup (such as calcium) within the water. Dissolve 1 to 2% citric acid in lukewarm water, let it sit in the product, and wash thoroughly about 3 hours later.
- For the inner container, dilute oxygen-based bleach or dish washing detergent in lukewarm water, put it in the container for about 30 minutes, and then wash with a soft sponge and dry thoroughly.
- Do not use chlorine bleach. (Doing so may cause rust to form.)
- When the outside of the main unit is dirty, moisten a soft cloth with warm water and a neutral detergent, wring it out firmly, wipe dirt from the product, then wipe dry with a dry cloth.
- Do not use bleach on the outside of the main unit. (Doing so may cause the surface to peel off.)
- Before storing the product, be sure to remove all dirt and dry thoroughly.

Troubleshooting

Problem	Inspection	Solution
Main unit	Is the inner stopper closed securely?	Securely close the inner stopper.
Heating or cooling is ineffective	Is the bottle damaged?	If the main unit is dented, the vacuum insulation layer may lose its retention and heating/cooling effectiveness may become impaired.
	Is there enough liquid inside?	Increase the amount of content.

Inner stopper	Is the inner stopper's gasket attached correctly?	Refer to the figure in the manual and attach the gasket correctly.
Liquid is leaking	A small amount of liquid may remain inside of the inner stopper.	After closing the open/close lever, tilt the spout downward to drain out any excess liquid before use.

* The inner stopper is an expendable part. Check its condition about six months to one year after initial use.

Attaching the shoulder strap

CAUTION

- Align the shoulder strap's fastener with the hook as shown, then pull it upward to lock it in place.
- After attaching it, pull the strap and check that it is securely attached.

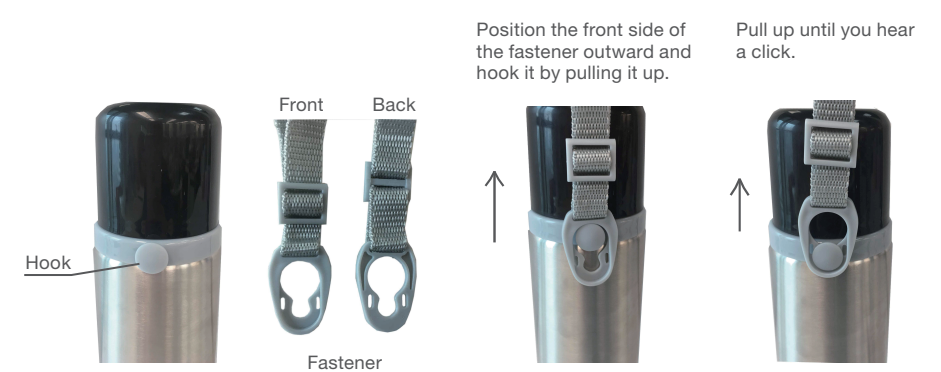

<SKN-SB387NF> Stainless Steel Portable Thermos User Manual

Important Read through this manual carefully before use. This manual is required when purchasing replacement parts, so keep it in a safe place.



Before Use

- Remove deodorizers from the inside before use.
- Check that all parts are included before use.
- Carefully wash the cup, main unit, and inner stopper before use.
- Always attach the cup when carrying the product. (This prevents inner stopper contamination.)

How to attach and remove the cup and inner stopper

- Remove by turning counterclockwise. Attach by turning clockwise as viewed from the top of the water bottle (tighten firmly)