

## User Manual

# Stainless Pot

Product No.: STP602

### Part Names

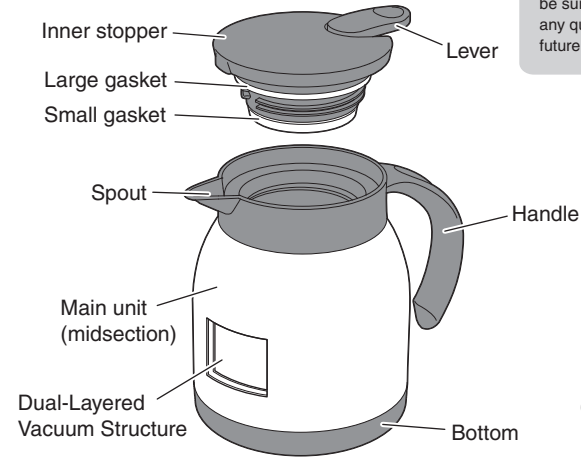

Thank you very much for purchasing our stainless pot. Please read through these instructions carefully for safe and proper handling before use. Also be sure to keep it handy in case any questions come up in the future regarding proper usage.

Capacity: 600 ml

## How to Use

\* Thoroughly wash the lid and main unit (midsection, inner bottle). Refer to "Product Care" for details.

### 1 Remove the lid

Twist the lid in the direction of the arrow to remove it.



### 2 Fill with a beverage

Fill up to the limit shown in the figure. Overfilling may cause the beverage to overflow when closing the lid.

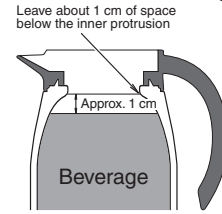

### 3 Close lid

Turn the lid in the direction of the arrow, and tighten it until the lever and handle are in alignment.

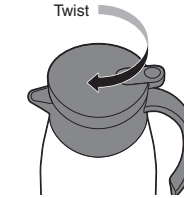

### 5 Pour beverage

① Hold the unit by the handle, and press down the lever while it is in a level position.



② Hold the lever down, and slightly tilt the unit forward to pour the beverage.



### 6 Stop pouring

① Hold the lever down, and return the unit to a level position.



② Release the lever.



### CAUTION

\* After pouring the beverage, holding the unit tilted forward and releasing the lever may cause some beverage remaining inside the lid to leak out, potentially causing a burns or soiling of property while in use.

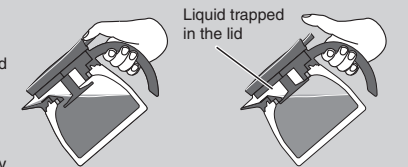

<Sectional view>

## Be sure to follow these instructions

### WARNING

- Only use this product to keep beverages warm or cool. (Failure to do so may lead to malfunction or accident.)
- Keep out of reach of children, and do not let children use this product unsupervised. Also, do not store this product where children are able to access it. Be sure it is not used for playing or pranks. (May cause burns or injury.)
- Keep away from fire, such as a heater or stove. Also be sure to keep away from direct sunlight, and do not use outdoors. (Failure to do so may deform or discolor the product.)
- Do not subject the product to significant shock or vibration by turning over it, dropping it, or hitting it against something. (Doing so could reduce the product's heat/cold retaining properties, causing it to malfunction or break.)
- When pouring in hot water, be sure to only use a small amount. Overfilling may increase internal pressure, causing contents to spray out. (May cause burns or injury.)
- Right after pouring in hot water, be sure to wait a few tens of seconds before putting on the lid. Otherwise, pressing the one-touch lever may increase internal pressure, causing contents to spray out. (May cause burns or injury.)

- Hold by the handle, press down the one-touch lever, and gradually tilt forward to pour the beverage. (Pressing down the one-touch lever after tilting the product forward may cause leakage, burns, or soiling of property.)
- After pouring the beverage into a cup, place the main unit on a level surface. (Failure to do so may cause leakage, burns, or soiling of property.)
- Do not use when located in a car, outdoors, or other areas where it may tip over. (Doing so may cause leakage, burns, or soiling of property.)
- Do not shake or turn over the pot. Also, be sure to carry the product by its handle. Contents may leak out. (Failure to do so may cause leakage, burns, or soiling of property.)
- When using a hot tea kettle, do not allow it to touch the mouthpiece. (Doing so may cause it to tip over, resulting in burns or injury. The product could also be scratched or deformed.)
- Close the lid securely before use. (If the lid is not fastened securely, leakage may occur, resulting in burns or soiling of property.)
- Do not use with ceramic cookware, etc. over a fire. (This is very dangerous and may cause a fire or burns.)
- Do not attempt to repair, disassemble, or modify this product. (Doing so may result in malfunction or accident.)

- Do not leave a beverage in this product for a long period of time. (Doing so may result in spoiled beverage or deterioration.)
- Drink tea etc. quickly. (Keeping tea in the product for a long time may cause the color or taste to change.)
- Be sure to perform product care after tea or coffee have been poured into it. (Otherwise beverages may no longer pour out.)
- Be sure to break large pieces of ice into smaller pieces before putting them in the product. (Failure to do so may scratch or damage the product, causing leakage.)

- Do not put canned juice, beer, etc. in the container. (Doing so may disfigure the product or cause it to malfunction.)
- Do not fill with alcoholic beverages.
- Never fill the product with the following:
  - \* Dry ice, carbonated drinks, etc. (Increased internal pressure may cause contents to spray out.)
  - \* Milk, dairy products, juice, etc. (This may spoil or cause a change in quality.)
  - \* Salty soups such as miso soup, etc. (May cause rust to form.)
  - \* Pulp, tea leaves, etc. (May cause clogging, leakage, etc.)

### Product Care

- Main unit (midsection)  
Use a dish detergent diluted with hot water to dampen a soft cloth, then wring it out, and wipe away any dirt. After that, use a soft dry cloth to dry it. This will maintain the unique luster of the stainless steel.
- Lid  
Remove the gaskets, then dampen a soft sponge with a dish detergent diluted with hot water, and wash the product. Make sure to rinse thoroughly with water when done, so that no detergent remains.

- Inner bottle  
Use a dish detergent diluted with hot water, and a sponge brush with a handle to wash, then dry thoroughly.

\* If the product is dirty or contains liquid for a long period of time, it may produce an unpleasant odor. Be sure to perform the proper care if this occurs.

\* If an odor is apparent, use a dish detergent diluted with hot water, and a sponge brush with a handle to wash, then dry thoroughly.

### Product Care Precautions

- Do not place in boiling water. (Heat from this may deform parts, causing leakage, resulting in burns or soiling of property.)
- Do not use a dish washer or dish dryer. (Heat from this may deform parts, causing leakage, resulting in burns or soiling of property.)
- Do not wash the main unit or lid without disassembling, and do not set to soak. (Doing so may cause water to seep through the cracks, soiling property, causing rust to form, or reduce temperature insulation.)
- Do not use paint thinner, benzene, metal scrubbers, polishing powder, cleansers, etc. (Doing so may cause scratches or rust to form.)
- Do not use chlorine bleach. (Doing so could cause rust to form or a malfunction to occur.)
- Attach gaskets correctly.
- When not using the product for a long period of time, wash it clean, then dry thoroughly and store in an area free of high-temperature and humidity.

### If you find rust-like red dots or rough spots forming on the pot's inner bottle

- If you see red, rust-like spots  
Use a dish detergent diluted with hot water to dampen a soft cloth, then wring it out, and wipe away any dirt. After that, use a soft dry cloth to dry it. This will maintain the unique luster of the stainless steel.
- If rough material is stuck inside  
Calcium, etc. from water is stuck to the unit. Pour lukewarm water with approx. 10% citric acid into the main unit, let it sit for three hours, then use a soft sponge, etc. to thoroughly wash the inside of the inner bottle. Make sure to rinse thoroughly with water when done, so that no citric acid remains.

### Things to note before using the dripper

- Be careful that the dripper does not tip over, etc. when using it.
- Some drippers cannot be used depending on the size.